

## Using SensusAccess

SensusAccess is an assistive technology tool that converts documents into more accessible formats. It is particularly useful for individuals with visual impairments (low vision, partially sighted, blind), dyslexia, difficulty concentrating and reduced reading skills. However, it is not restricted to people with disabilities. For instance, anyone interested in converting documents to different formats, such as turning a scanned document into Word, or those who prefer listening to reading, can also benefit from it.

## How to convert files

You can convert files on Absalon or use the Sensus tool available on [KUNet](#).

### Absalon

Visit the relevant course room where the page or file you wish to convert is available.

Find the file or page.

Click on the  symbol on the right.

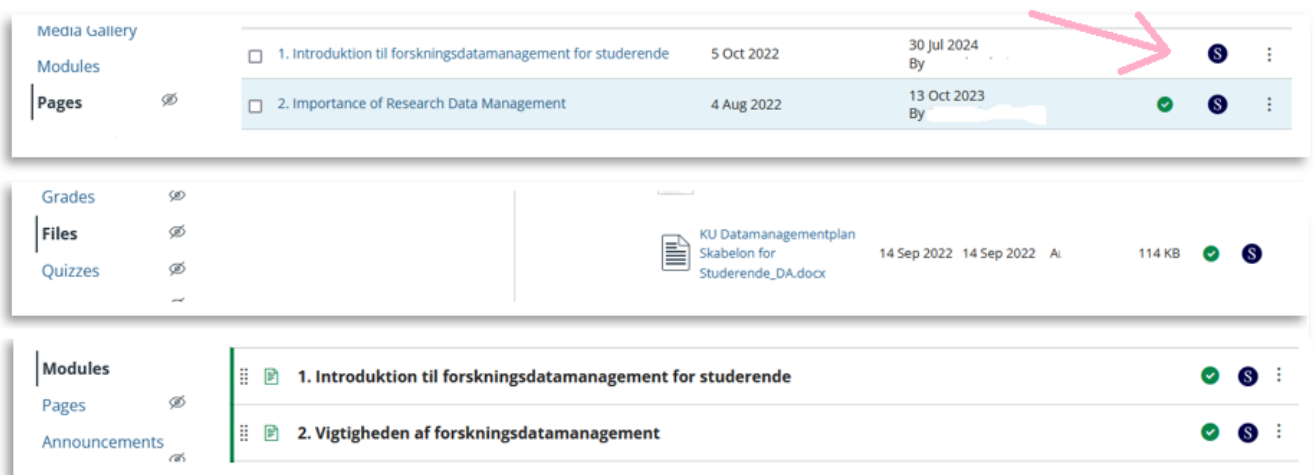

The screenshot shows the Absalon interface with three sections: Media Gallery, Files, and Modules. In the Media Gallery, two items are listed: '1. Introduktion til forskningsdatamanagement for studerende' and '2. Importance of Research Data Management'. A pink arrow points to the Sensus icon (a blue circle with a white 'S') next to the second item. In the Files section, a document 'KU Datamanagementplan Skabelon for Studerende\_DA.docx' is shown with a Sensus icon. In the Modules section, two items are listed: '1. Introduktion til forskningsdatamanagement for studerende' and '2. Vigtigheden af forskningsdatamanagement', both with Sensus icons.

If you are trying to convert an Absalon page, you will be prompted to specify whether you want to convert the entire page (*‘page content’*) or a specific file within the page.

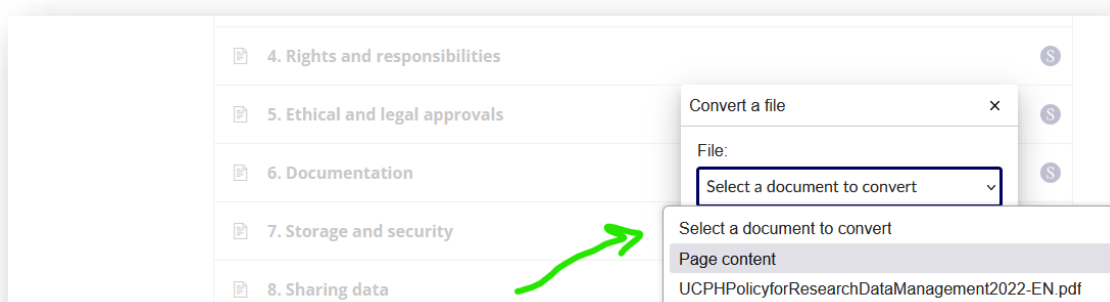

The screenshot shows a list of course items: '4. Rights and responsibilities', '5. Ethical and legal approvals', '6. Documentation', '7. Storage and security', and '8. Sharing data'. A green arrow points to the Sensus icon next to item 7. A dialog box titled 'Convert a file' is open, showing a 'File:' dropdown menu with 'Select a document to convert' selected. Below the dropdown, there are two options: 'Page content' and 'UCPHPolicyforResearchDataManagement2022-EN.pdf'.

Define the conversion type and the conversion parameters.

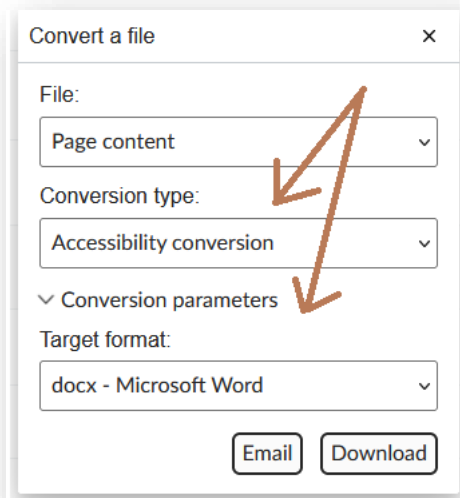

Choose 'E-mail' or 'Download' depending on how you would like to receive the file.

## KUnet

On the KUnet page '*Sensus- make your formats accessible*' you can convert content by uploading a file, entering a URL or typing in the text you wish to convert. Visit the [page](#) to learn more.

## What can you do as a teacher?

### 1. Be mindful of the formats that can be converted

SensusAccess does not support all source formats. The source formats supported can be seen below:



SensusAccess can convert files mainly composed of text and files that meet accessibility requirements. It can, unfortunately, not convert

- Illustrations
- Equations
- Non-textual content
- Protected documents

## 2. Inform students about its possibilities

SensusAccess is a tool you can introduce, but ultimately, students themselves must use it. What you could do as a teacher is let them know the software exists and can help them. See below what SensusAccess can do.

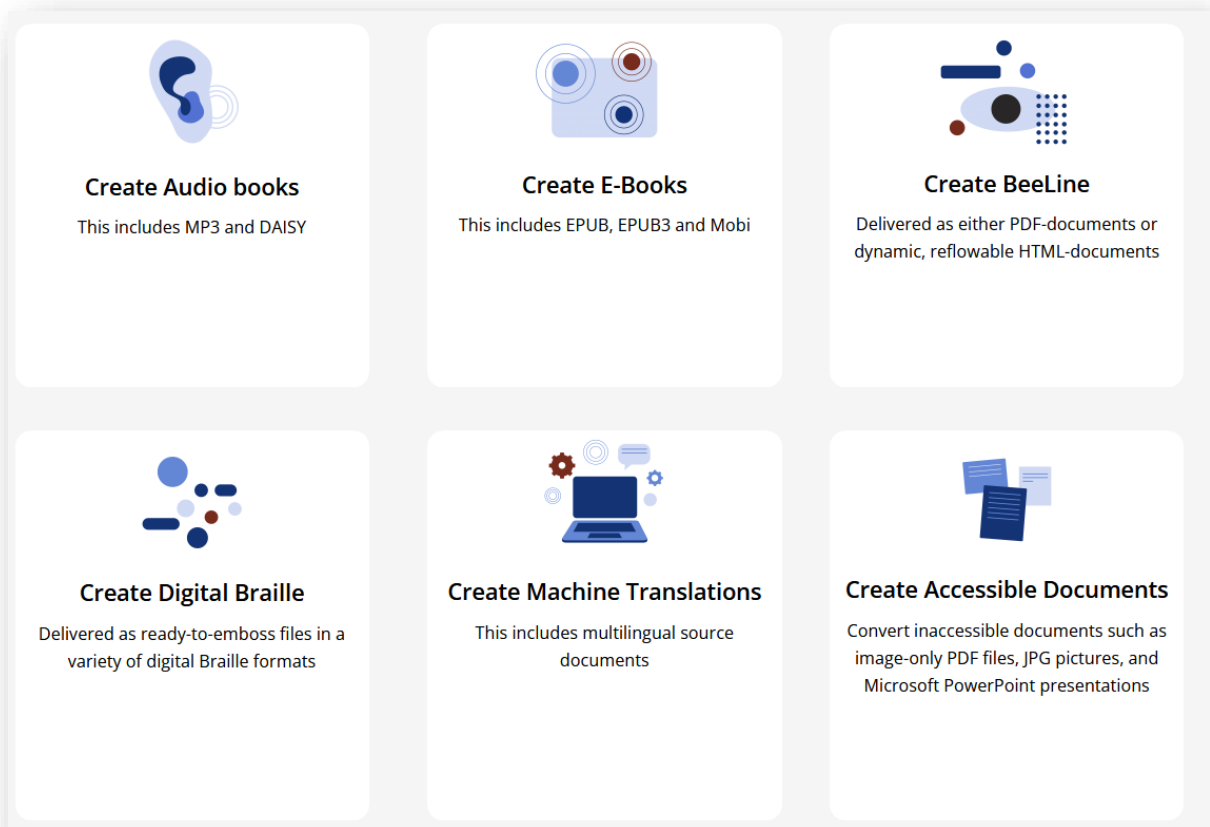

## 3. Enable SensusAccess if it is not already enabled

Sensus access is by default activated in all course rooms. You know that Sensus Access is activated if you go to 'Modules' and the 'S' symbol appears on the left of the content that can be converted (see green arrow below).

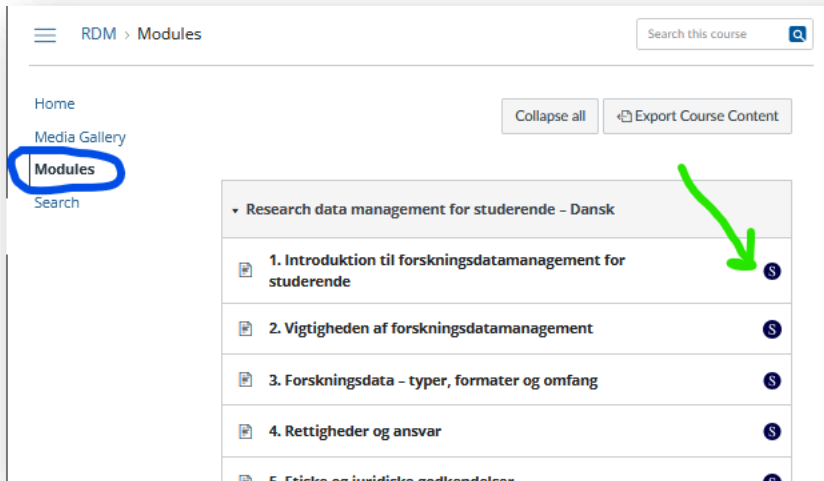

In the unlikely event that Sensus Access is not enabled in your Absalon course, go to the course [Settings](#) and click on 'Enable Sensus Access Inside' (see below)

